

MR0102

MRT2021BAKOA/R/0.3M/ASR

Magnetic sensors, cylinder sensors

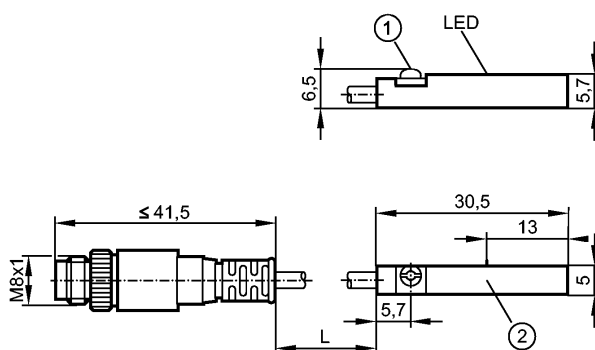

- 1: Fastening clamp
2: sensing face



Made in Germany

Product characteristics

Cylinder sensor with reed contact

Plastic housing for T-slot cylinders

Cable with connector

[f] flush mountable

Magnetic sensitivity 2.1 mT

Travel speed > 10 m/s

Electrical data

Electrical design	AC/DC PNP/NPN
Operating voltage [V]	5...60 DC / 5...50 AC; (for UL supply class 2: 5...60 DC / 5...30 AC)
Protection class	III
Reverse polarity protection	yes

Outputs

Output function	normally open
Voltage drop [V]	< 5
Current rating [mA]	100 *)
Short-circuit proof	no
Overload protection	no
Switching frequency [Hz]	1000
Switching power (max.) [W]	10

Range

Magnetic sensitivity [mT]	2.1
Travel speed [m/s]	> 10

Accuracy / deviations

Hysteresis [mm]	1
Repeatability [mm]	± 0.2

Reaction times

Fall time [ms]	≤ 0.1
Make time incl. bounce [ms]	≤ 0.6

Environment

Ambient temperature [°C]	-25...70
Protection	IP 67

Tests / approvals

MR0102

MRT2021BAKOA/R/0.3M/ASR

Magnetic sensors, cylinder sensors

EMC	EN 61000-4-2 ESD:	- CD / 8 kV AD
	EN 61000-4-3 HF radiated:	10 V/m (80...2000 MHz)
	EN 61000-4-4 Burst:	2 kV
	EN 61000-4-5 Surge:	1 kV (line to line, Ri: 20hm)
	EN 61000-4-6 HF conducted:	10 V (0.15...80 MHz)
	EN 55011:	class B
MTTF	[Years]	11303

Mechanical data

Mounting	flush mountable
Housing materials	housing: PA (polyamide); Fastening clamp: stainless steel
Switching cycles when connected to PLC [million]	≤ 40
Weight	[kg] 0.015

Displays / operating elements

Output status indication	LED	yellow
--------------------------	-----	--------

Electrical connection

Connection	PUR cable / 0.3 m; with M8 connector, with turnable coupling ring
------------	-------------------------------------------------------------------

Wiring

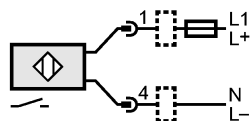

Note: miniature fuse to IEC60127-2 sheet 1,
≤ 0.175 A (fast acting)

Accessories

Accessories (included)	rubber placeholder; cable clip
------------------------	--------------------------------

Remarks

Remarks	<p>*) External protective circuit for inductive load (valve, contactor, etc.) necessary.</p> <p>Clamping screw with combined slot/hexagon socket head AF 1.5</p> <p>No LED function in case of polarity reversal in DC operation.</p> <p>UL - Class 2 source required</p>
---------	---------------------------------------------------------------------------------------------------------------------------------------------------------------------------------------------------------------------------------------------------------------------------

Pack quantity	[piece] 1
---------------	-----------